



2000 I-30 E  
Greenville, TX 75402

Thursday, December 9, 2021

Office of Hopkins County Judge  
PO Box 288  
Sulphur Springs TX 75483

Farmers Electric Cooperative Member: DANIEL KNUDSON  
Service Order Number: 2021116196

Greetings:

Farmers Electric Cooperative, Inc. is requesting permission to construct electrical power distribution facilities which will cross County Road 3344 which is located 875 FT NW OF CR 3349 in Hopkins County, Texas.

Site location map and construction sketches are enclosed. The construction sketch details the proposed work. All underground bore crossings are PVC encased 4' of coverage from the lowest point of the Right of Way.

If you have any questions, please contact me at any time.

Sincerely,

*Tamara Williams*  
Project Coordinator  
twilliams@farmerselectric.coop  
Phone 903-513-2903

Submitted by Psalm Harper  
pharper@farmerselectric.coop  
Field Engineering Coordinator

Enclosures

County Approval Section:

Approved:  Denied:

Authorized Signature: *Wade Bentley* Date: 12-10-21

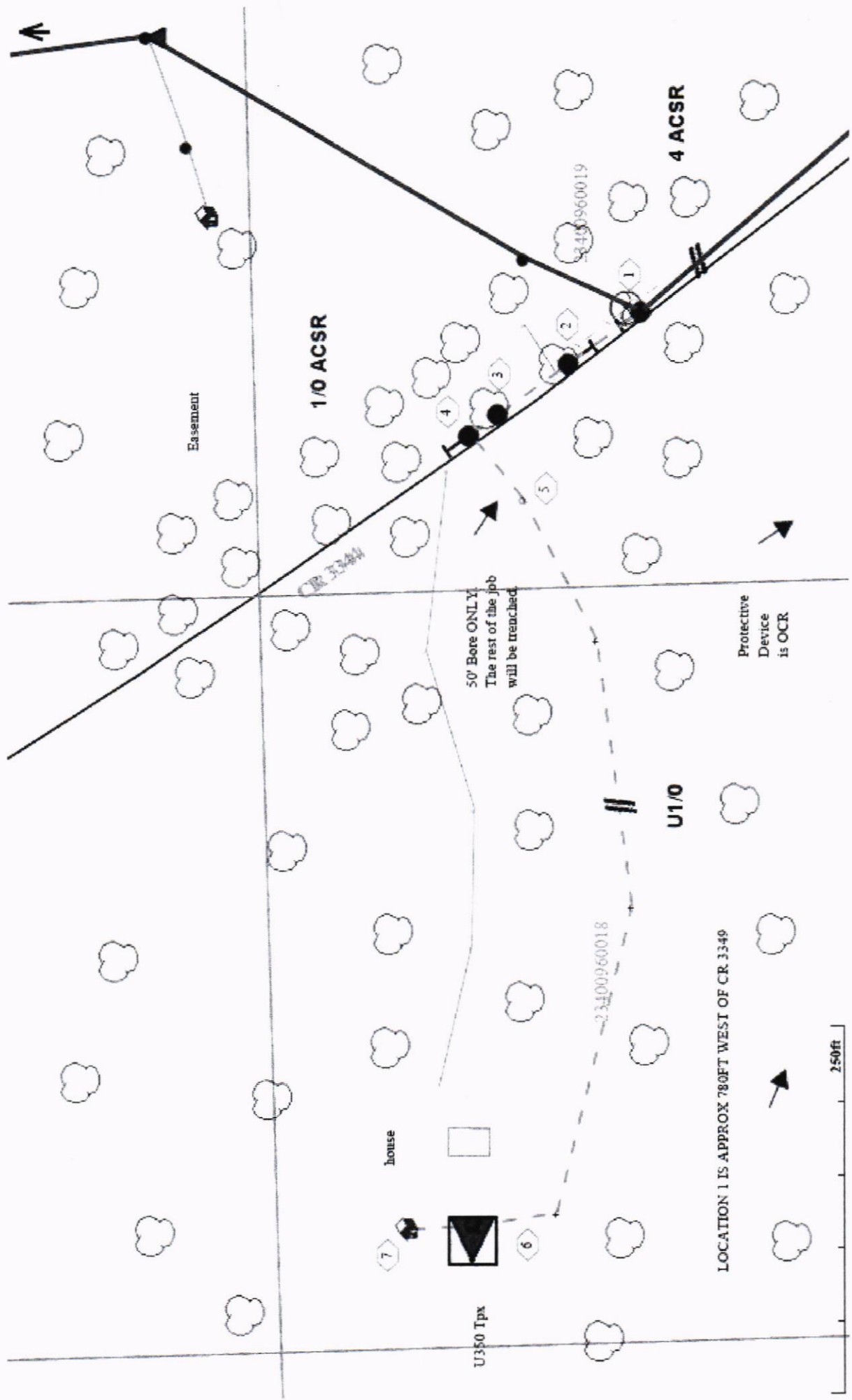

LOCATION 1 IS APPROX 780FT WEST OF CR.3340

250ft

SVT

NORTH EAST SERVICE AREA

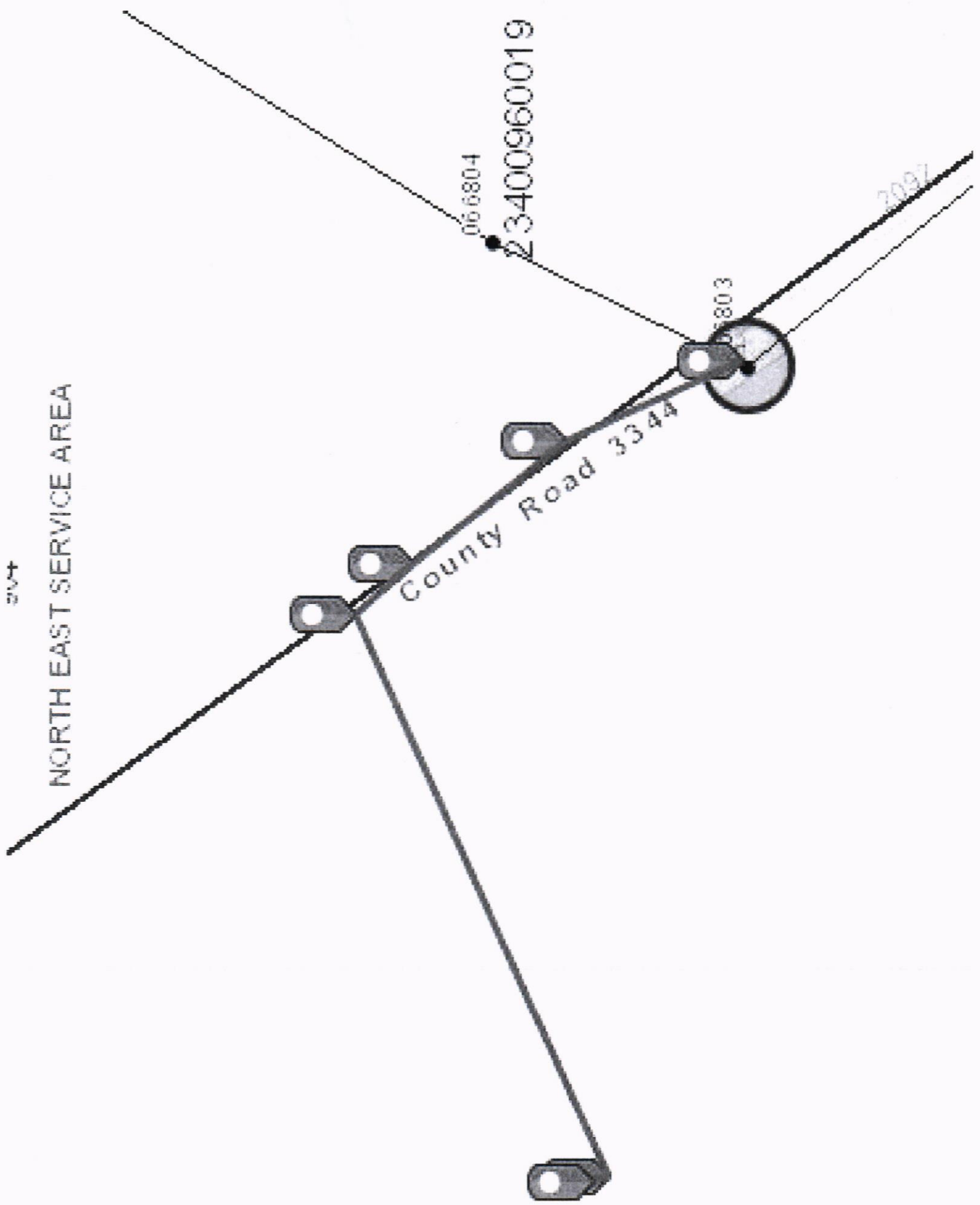

066804

23400960019

3344

2097

County Road 3344

3344